









| STEEL LINTELS | | | (NON-LOAD BEARING WALLS) | | | |
|---------------|---|-----------------|---|------------------|---|-----------------|
| CLEAR SPAN | 200 WALL | | 250 WALL | | 300 WALL | |
| | TYPE | MATERIAL | TYPE | MATERIAL | TYPE | MATERIAL |
| UP TO 1220 |  | 2-L's 90x90x8 |  | 2-L's 100x100x8 |  | 3-L's 90x90x8 |
| 1220 - 1800 |  | 2-L's 100x75x8 |  | 2-L's 100x100x10 |  | 3-L's 125x90x8 |
| 1800 - 2200 |  | 2-L's 125x90x10 |  | 2-L's 125x90x13 |  | 3-L's 125x90x10 |

NOTES FOR NON-LOADBEARING WALL LINTELS

1. Pairs of lintel angles to be bolted or stitch welded top and bottom @ 600 c/c max.
2. Minimum bearing for steel linteels to be 150 unless noted otherwise.
3. Provide steel packing PL's to ensure even bearing.
4. For walls over 300 thick add 1 L for each additional 100 of wall thickness or portion thereof.
5. For linteels abutting steel columns, concrete walls or columns provide L-90x90x10 shelf angle.

| BLOCK LINTELS (NON-LOAD BEARING WALLS) | | | |
|--|--------------------|--------------------|--------------------|
| CLEAR SPAN | 100 WALL | 150 WALL | 200 WALL |
| UP TO 1220 | 1-10M TOP & BOTTOM | 1-10M TOP & BOTTOM | 2-15M TOP & BOTTOM |
| 1220 - 1800 | 1-15M TOP & BOTTOM | 1-15M TOP & BOTTOM | 2-15M TOP & BOTTOM |

NOTES FOR LINTEL BLOCKS

1. Minimum bearing for lintel blocks to be 200mm
2. Fill voids of lintel blocks with 20 MPa Concrete, Mortar is not acceptable

| 4" BRICK VENEER | | (NON-LOAD BEARING WALLS) | |
|-----------------|----------------------------|--------------------------|---------------------------|
| CLEAR SPAN | | CLEAR SPAN | |
| UP TO 4'-0" | L-90x90x6 (L3.5x3.5x1/4") | 7'-0" - 8'-0" | L-125x90x8 (L5x3.5x5/16") |
| 4'-0" - 5'-0" | L-90x90x8 (L3.5x3.5x5/16") | 8'-0" - 9'-0" | L-125x90x10 (L5x3.5x3/8") |
| 5'-0" - 7'-0" | L-100x90x8 (L4x3.5x5/16") | 9'-0" - 10'-0" | L-150x100x10 (L6x4x3/8") |

NON-LOAD BEARING MASONRY WALL LINTEL SCHEDULE

[illegible]

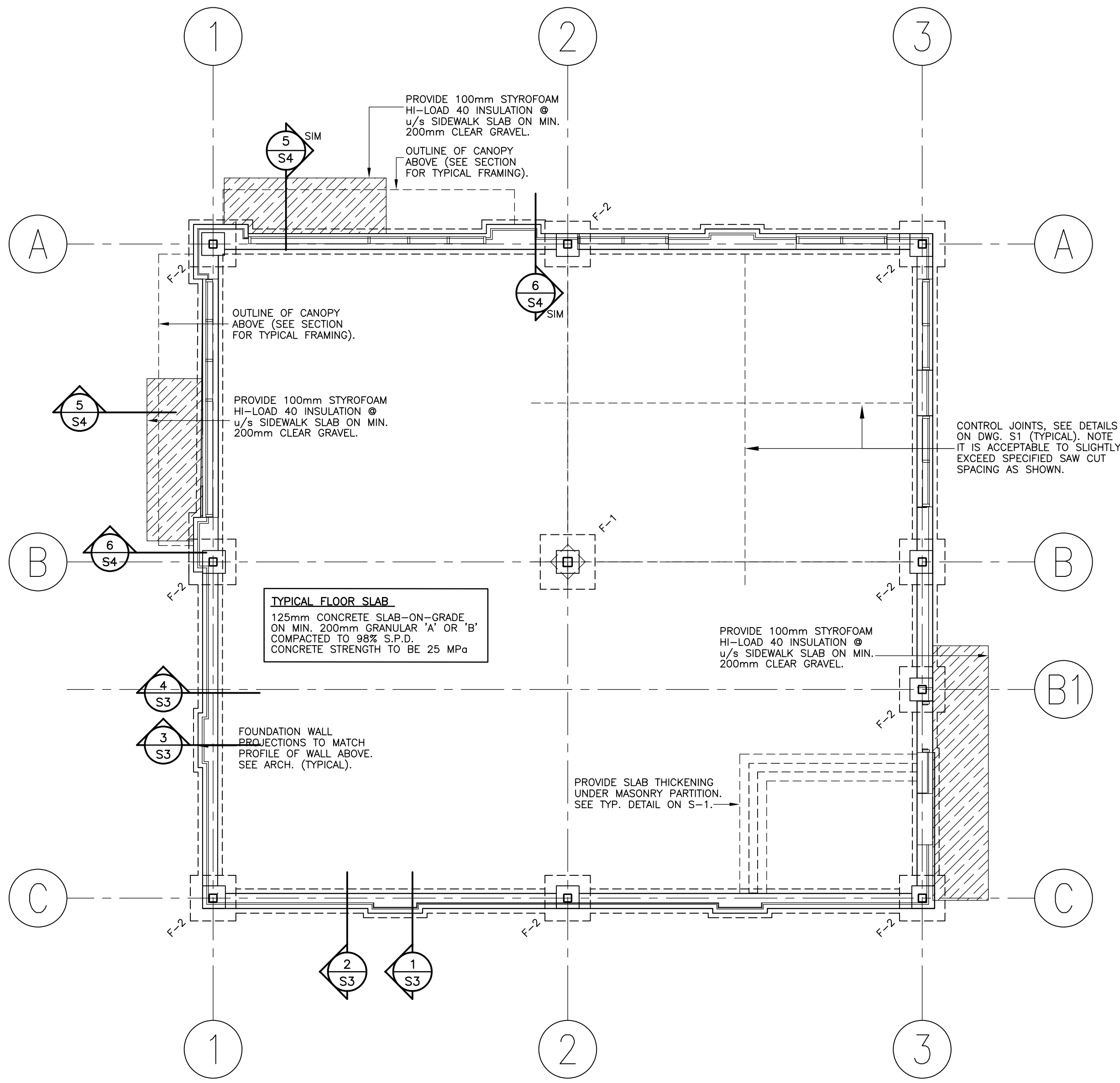

FOUNDATION PLAN
1 : 75

| FOOTING SCHEDULE | | | | | |
|------------------|---------------|---------------------|-----------|------------------------------------|----------|
| MARK | SIZE | REINFORCING | PIER SIZE | PIER REINF. | COMMENTS |
| F-1 | 1200x300x1200 | 5 - 15M BOTT. E. W. | 500x500mm | 4 - 25M VERT. + 10M TIES @ 250 c/c | |
| F-2 | 1000x300x1000 | 4 - 15M BOTT. E. W. | 500x500mm | 4 - 25M VERT. + 10M TIES @ 250 c/c | |

FOUNDATION DESIGN HAS BEEN BASED ON AN ASSUMED ALLOWABLE SOIL BEARING CAPACITY OF 150 kPa. SEE NOTES ON DRAWING 'S1.1' FOR MORE INFORMATION.

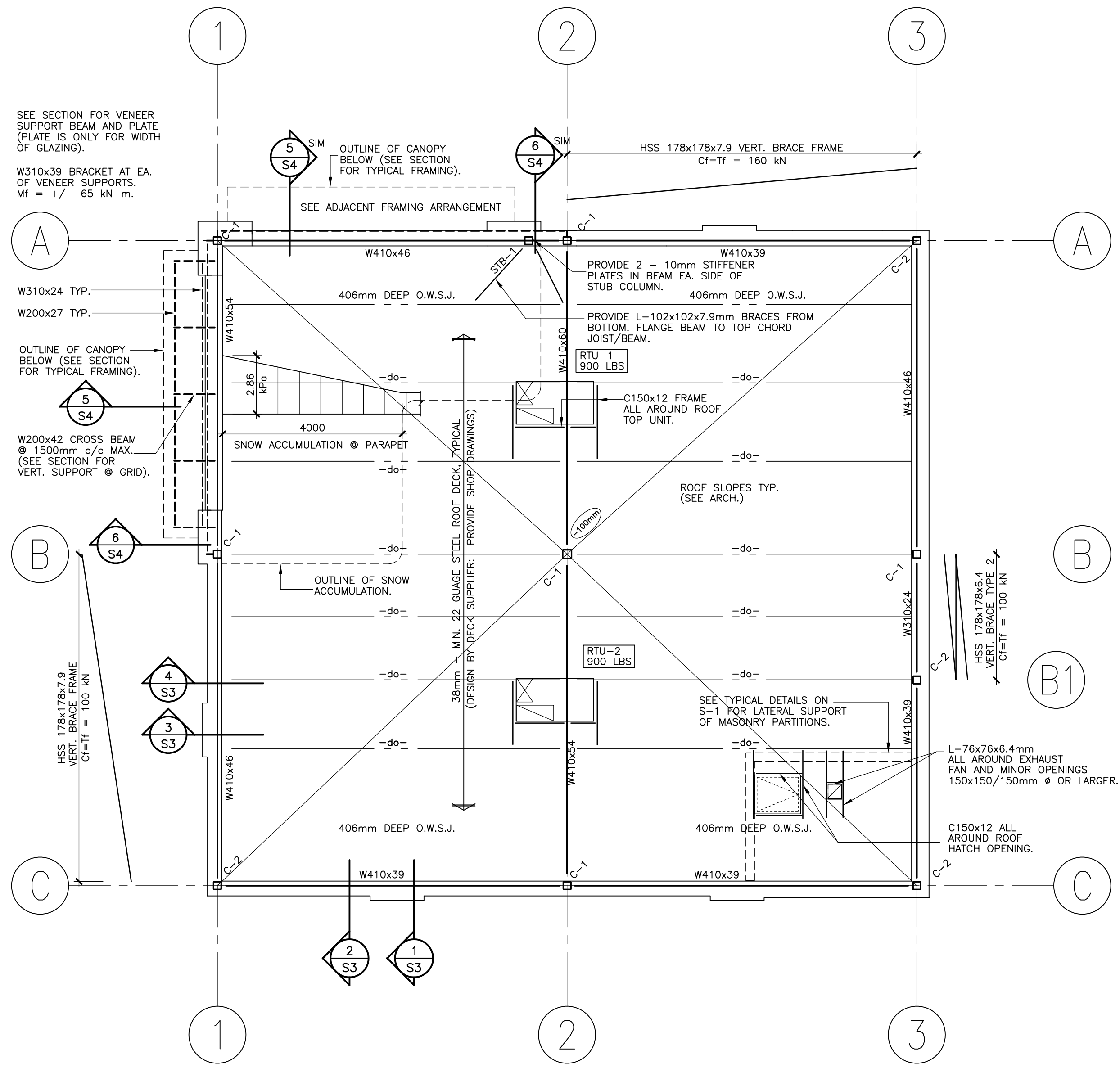

ROOF FRAMING PLAN
1:100

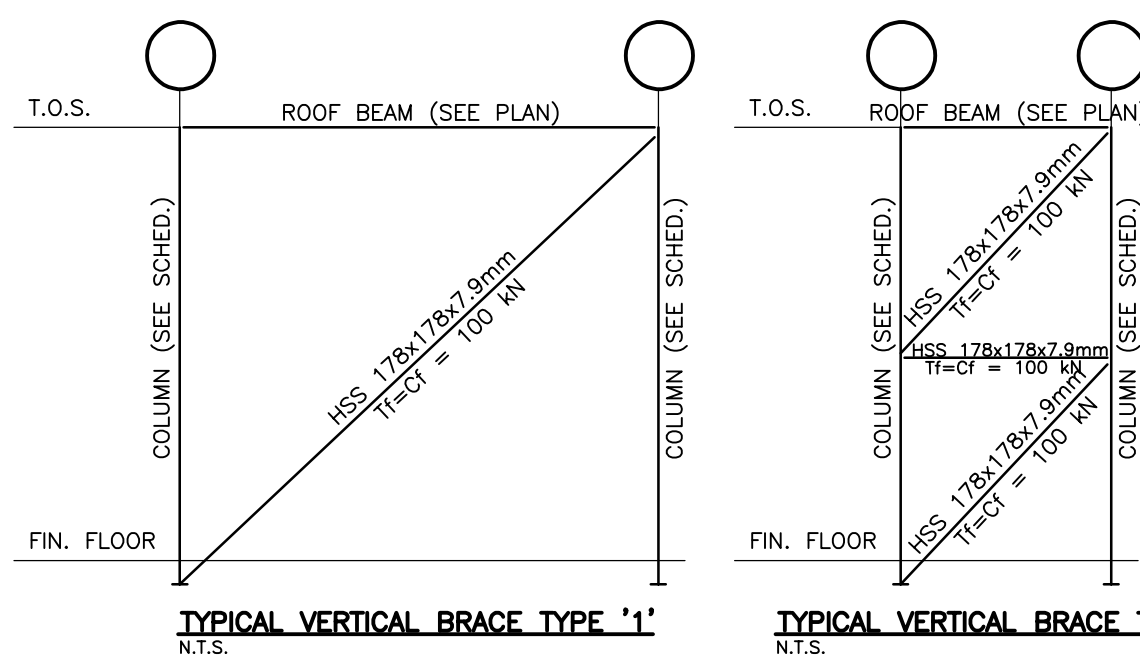

STRUCTURAL NOTES:

1. ASSUMED ROOF LOADING:
LIVE LOAD: 2.0 kPa + SNOW ACCUM.
DEAD LOAD (MAIN ROOF):
DECK: 0.1 kPa
INSUL./ROOFING: 0.45 kPa
FRAMING: 0.15 kPa
CEILING: 0.25 kPa
MISC./MECH.: 0.25 kPa
TOTAL D.L.: 1.2 kPa
DEAD LOAD (STUD HALF TRUSSES):
ASPHALT SHINGLES: 0.15 kPa
SHEATHING: 0.1 kPa
FRAMING: 0.2 kPa
TOTAL D.L.: 0.45 kPa

2. COLUMN SCHEDULE:

- ALL COLUMNS 'C-1': HSS 178x178x7.9mm COLUMN ON 350x350x20mm BASE PLATE + 4 - 20mm DIA. A307 ANCHORS x 600mm LONG + 75mm HOOK.
ALL COLUMNS 'C-2': HSS 178x178x6.4mm COLUMN ON 350x350x25mm BASE PLATE + 4 - 20mm DIA. A307 ANCHORS x 600mm LONG + 75mm HOOK.
ALL COLUMNS 'STB-1': HSS 178x178x7.9mm COLUMN WELDED ALL AROUND TO TOP OF ROOF BEAM.
ANCHORAGE AT ALL BRACING AND MOMENT FRAME LOCATIONS:
4 - 25mm DIA. A307 ANCHORS x 800mm LONG + 75x75x6.4mm PLATE WASHER & DOUBLE NUT CAST IN FOUNDATION PIER FOR ALL COLUMNS ADJACENT BRACING & MOMENT FRAMES. (THIS SUPERCEDES SCHEDULE ABOVE).

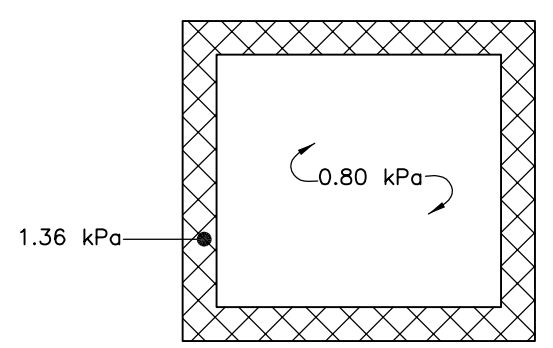

ROOF UPLIFT DIAGRAM
PRESSURES SHOWN ARE NET FACTORED.

| Date | Revision Description | No. |
|--|-----------------------------|----------------------------|
| 03.31.2026 | ISSUED FOR PERMIT & PRICING | 2 |
| 01.28.2026 | GENERAL REVISIONS | 2 |
| 09.11.2024 | ISSUED FOR PERMIT | 1 |
| Date | Issue Description | No. |
| 03.31.2026 | ISSUED FOR PERMIT & PRICING | 2 |
| 01.28.2026 | GENERAL REVISIONS | 2 |
| 09.11.2024 | ISSUED FOR PERMIT | 1 |
| Contractor must check and verify all dimensions and be responsible for same, reporting any discrepancies to the Engineer before commencing work. Prints shall not be used for construction until signed 'Approved For Construction' by the Engineer. Prints are not to be scaled. All drawings, prints and specifications are the property of the Engineer and shall be returned to him on completion of the work. © Mirkwood Services Inc. 2019 | | |
| | | Drawn By: KJ |
| | | Checked By: RK |
| | | Approved for Permit: |
| | | Approved for Construction: |
| | | |
| MIRKWOOD ENGINEERING UNIT 216, 5045 MAINWAY BURLINGTON, ON L7L 5H9 T:(905) 849 0062 F:(905) 849 6303 | | |
| Project: BRESLAU CENTER BUILDING F WOOLWICH, ON | | |
| Drawing Title: FOUNDATION PLAN | | |
| Scale: AS NOTED | Plot Date: | S2 |
| Date: AUGUST, 2024 | Drawing Number: | |
| Project Number: 24049 | | |

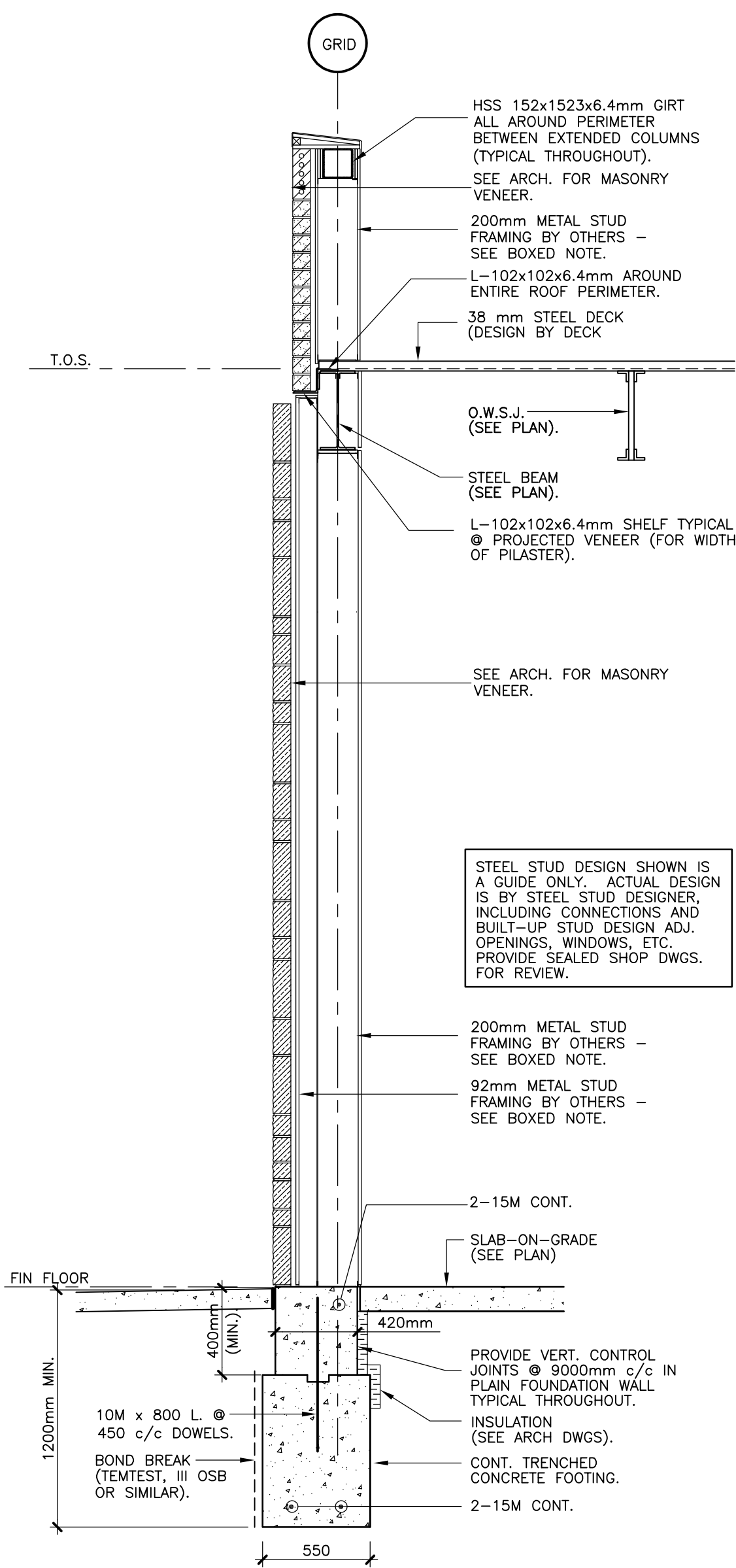

SECTION 1
1 : 25 S3

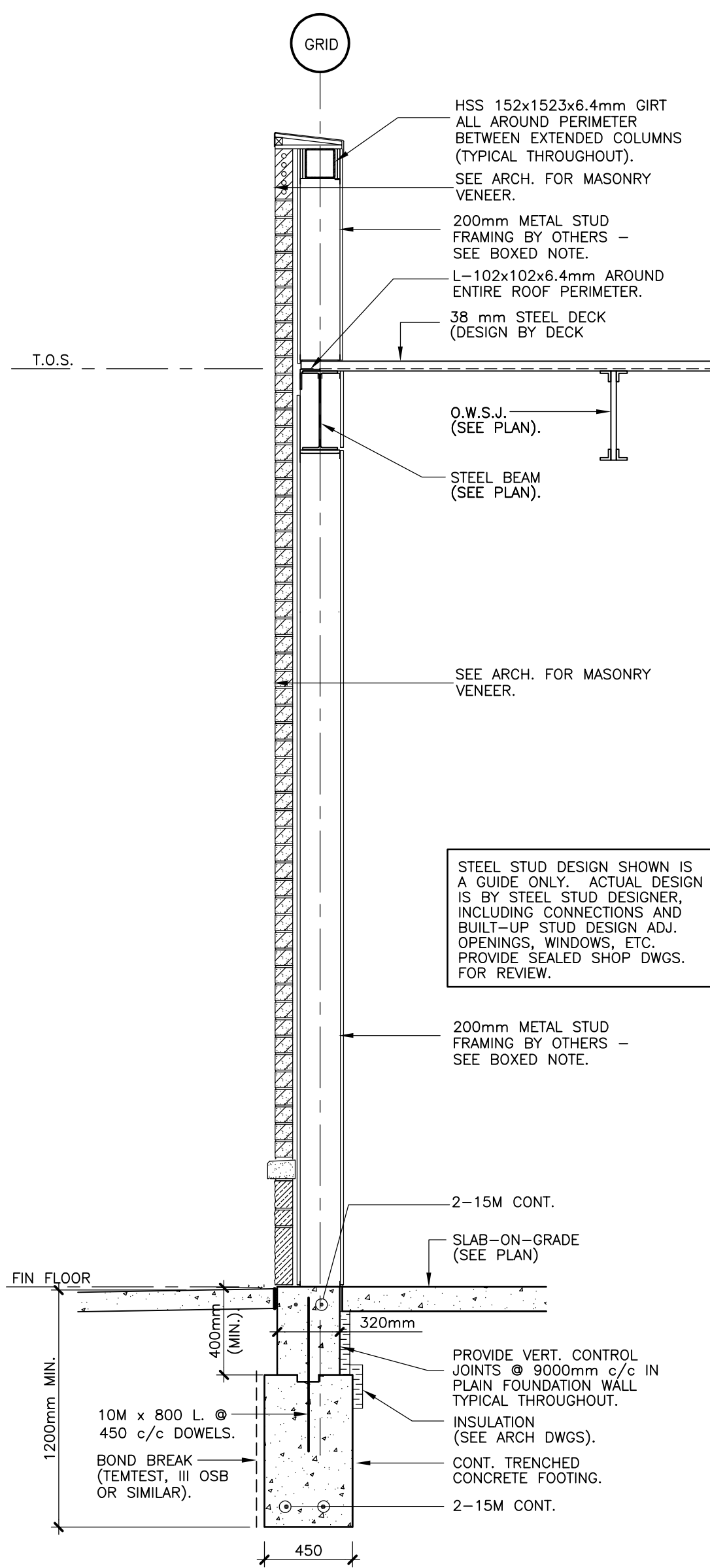

SECTION 2
1 : 25 S3

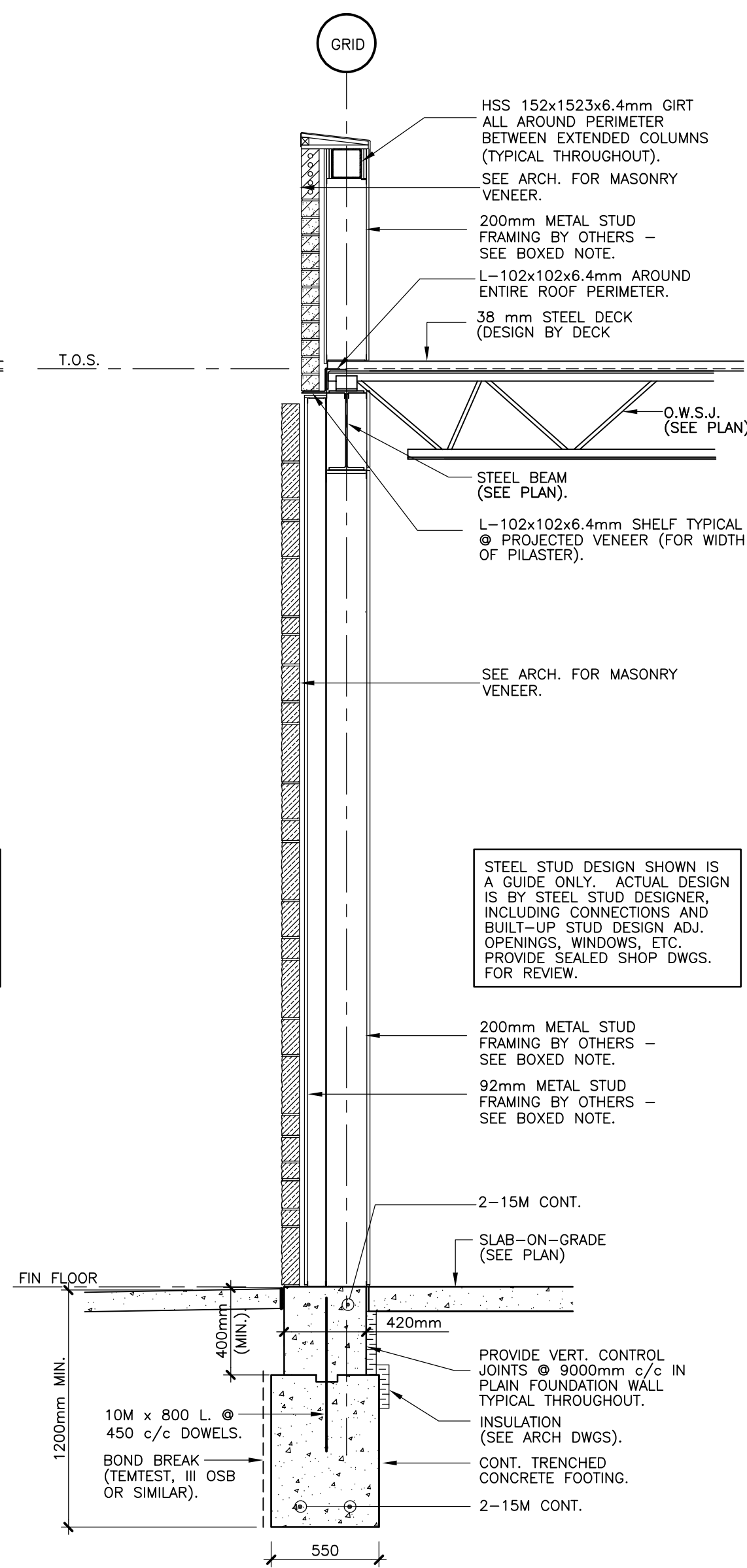

SECTION 3
1 : 25 S3

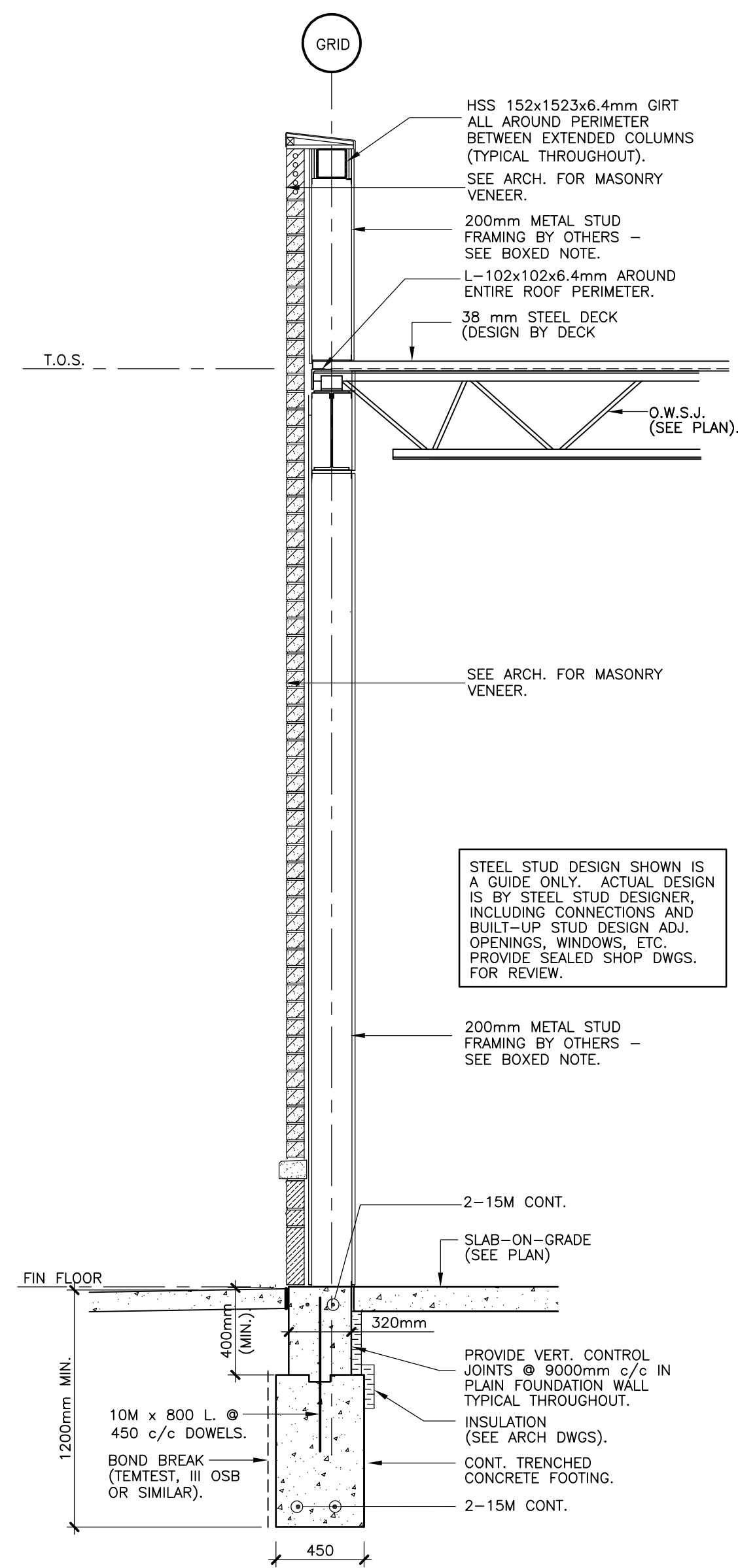

SECTION 2
1 : 25 S3

| Date | Revision Description | No. |
|------|----------------------|-----|
| | | |
| | | |
| | | |
| | | |
| | | |
| | | |
| | | |
| | | |
| | | |

| | | |
|------------|-----------------------------|---|
| 03.31.2026 | ISSUED FOR PERMIT & PRICING | 2 |
| 09.11.2024 | ISSUED FOR PERMIT | 1 |

| Date | Issue Description | No. |
|------|-------------------|-----|
| | | |
| | | |
| | | |
| | | |
| | | |
| | | |
| | | |
| | | |
| | | |

Contractor must check and verify all dimensions and be responsible for same, reporting any discrepancies to the Engineer before commencing work.

Prints shall not be used for construction until signed 'Approved For Construction' by the Engineer.

Prints are not to be scaled.

All drawings, prints and specifications are the property of the Engineer and shall be returned to him on completion of the work.

© Mirwood Services Inc. 2019

Drawn By: **KJ**

Checked By: **RK**

Approved For Permit:

Approved For Construction:

MIRKWOOD ENGINEERING
UNIT 210, 5045 MAINWAY
BURLINGTON, ON, L7L 5H9
T: (905) 849 0062
F: (905) 849 6303

Project
BRESLAU CENTER BUILDING F
WOOLWICH, ON

Drawing Title
SECTIONS

| | | |
|----------------|--------------|----------------|
| Scale | AS NOTED | Plot Date |
| Date | AUGUST, 2024 | Drawing Number |
| Project Number | 24049 | S3 |